

# Service Bulletin

Page 1 of 2

Date: January 2002

Bulletin No: 11 001 02 (002)

## BMW Motorcycles

**Subject:** Slip-ring seal for oil/water pump,  
all K 75, K 100, K 1100 models.

**Details:** All K 75, K 100, and K 1100 now share the the same slip-ring seal, spacer and impeller as the K 1200 RS/LT.

**Service Measures:** When making repairs to the oil/water pump, the updated slip ring seal (3) should be used. This updated slip ring **must** be installed in conjunction with updated spacer (2) and sheet metal impeller (1).

Follow installation instructions as outlined in the K 1200 RS Service Manual.

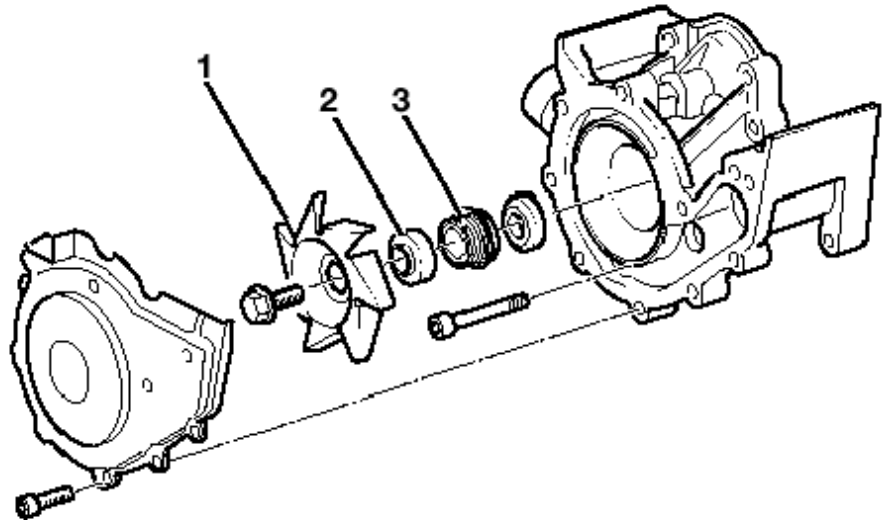

**Parts Information:** The updated parts carry the following part numbers.

Metal impeller (rotor): 11 41 1 461 173  
Picture reference #1

Spacer: 11 51 1 464 902  
Picture reference #2

Slip ring seal: 11 51 1 704 084  
Picture reference #3

**Important note:** Use BMW special tool No. 11 6 724 to install the updated slip ring seal. Failure to do so will result in an incorrect seating of the seal. Refer to the K 1200 RS Service Manual for installation instructions.



**Warranty Information:** **Not a warranty issue.** This information is supplied to inform retailers of the availability of updated replacement parts.

A stylized, handwritten signature in black ink, consisting of several loops and a long horizontal stroke extending to the right.

**Thomas J. Plucinsky**  
General Manager  
BMW Motorcycles

A handwritten signature in black ink that reads "Pat Raymond" in a cursive, flowing script.

**Pat Raymond**  
Service and Technical Manager  
(201) 307 4261  
[pat.raymond@bmwna.com](mailto:pat.raymond@bmwna.com)